





# MP 20/30

Pompe a membrana a media pressione

Medium pressure diaphragm pumps

Pompes a membrane a pression moyenne

Bombas con membrana de media presion

Membranpumpen mit mittlerem druck

VERSIONE STANDARD  
VERSION STANDARD  
VERSION STANDARD  
VERSION ESTÁNDAR  
STANDARDAUSFÜHRUNG



- Albero a 6 fori
- Six-Holes shaft
- Arbre percé 6 trous
- Cigüenal a seis agujeros
- 6-Loch-Welle

VERSIONI DERIVATE DA STANDARD  
VERSIONS ADAPTED FROM THE STANDARD  
VERSIONS DÉRIVÉES DE VERSIONS STANDARD  
VERSIONES DERIVADAS DE LA ESTÁNDAR – VON DER  
STANDARDAUSFÜHRUNG ABGELEITETE MODELLE



- Flangiata a motore idraulico
- Flanged to hydraulic motor
- Accouplée à moteur hydraulique
- Acoplada a motor hidráulico
- Geflanscht an hydraulischen Motor



- Puleggia
- Pulley
- Poulie
- Polea
- Keilriemenscheibe

Tipo Gole	Type of groove	Ø P	A
2A	172	124	
2A	247	127	
2A	292	127	

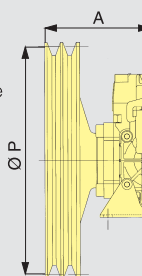

- Cardano 1" 3/8
- 1" 3/8 male PTO
- Cardan mâle 1" 3/8
- Cigüenal estriada 1" 3/8
- Für Kardan 1" 3/8

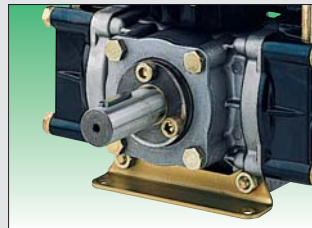
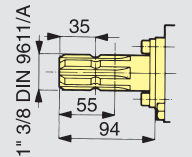

- Albero cilindrico Ø30 mm
- Solid shaft Ø30 mm
- Cardan mâle cyl. diamètre Ø30 mm
- Cigüenal cilíndrico diámetro Ø30 mm
- Zylindrische Welle Ø30 mm

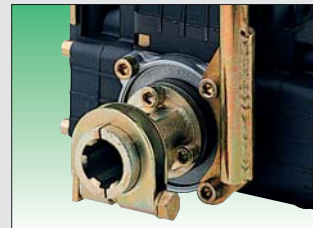
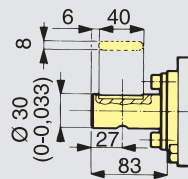

- Attacco rapido 1" 3/8
- Quick coupling 1" 3/8 spl. (female 1" 3/8 PTO)
- Accouplement 1" 3/8 femelle
- Enganche rápido 1" 3/8
- Schnellkupplung 1" 3/8

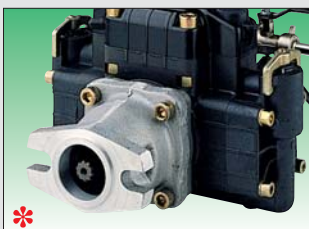
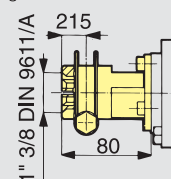

- Flangiata
- Flanged
- Bridée
- Con brida
- Geflanscht

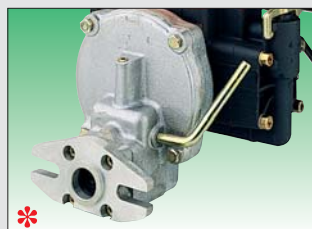

- Flangiata per motozappe
- Flanged for motor-hoes
- Bridée pour motobineuses
- Con acoplamiento para motocultores
- Anflanschung für Motorhackmaschinen



- Riduttore di giri
- Gearbox reduction
- Réducteur
- Reductor para motor
- Untersetzungsgetriebe

\* Le dimensioni variano in base al tipo di applicazione.  
\* Dimensions vary depending on the type of application.  
\* Les dimensions varient selon le type d'application.  
\* Las dimensiones varían en función del tipo de aplicación.  
\* Die Abmessungen ändern sich in Abhängigkeit von der Art der Anbringung.